

SWINGPRO

BE GAME-WINNER WITH REAL-TIME SWING ANALYZER

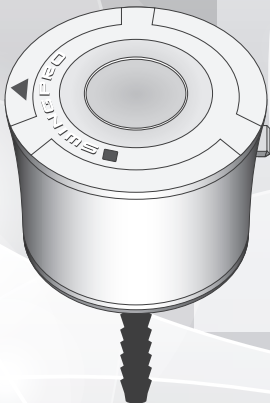

Swingpro 200 Manual

The Swingpro is targeted at home electromagnetic interference standard (B rate) and could be also used at whole area. External shape and specification could be changed for improving quality without any notification.

Copyright 2015 #990016-101 Rev 1.0

Contents

Contents

1. Swingpro 200?	3
2. Definition of parts' name	4
3. Parts list	5
4. Pre-caution	6
5. Preparing before using	7
6. Trouble shooting	12
7. Specification & Certificate	13
8. Notification of user compensation	14
9. Warranty notification & Guarantee	15

Swingpro 200?

Swingpro 200?

Swingpro 200 could be used in all kinds of golf clubs including Driver, Wood, Hybrid, Iron and Putter.

After swing, it analyzes, displays and sounds all data (Swing Plane, Swing Path, Rhythm&Tempo, Head Face Angle, Head Speed, Attack Angle, Lie Angle and etc.) at real time. Also by comparing with professional golfer's data, users could straighten things out their own swing motion, posture and other activity effectively.

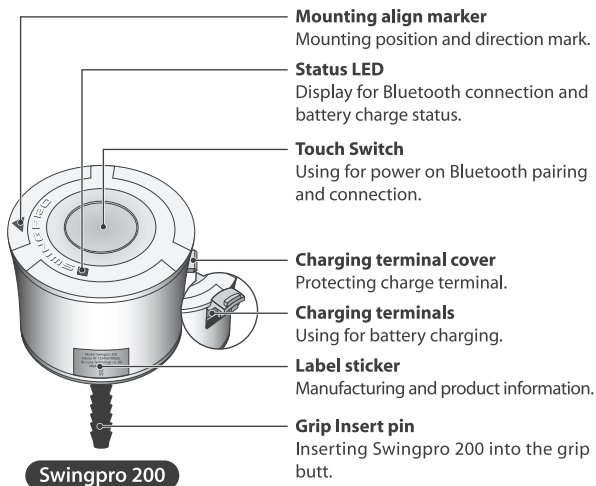

Definition of parts' name

Definition of parts' name



Parts list

Parts list

	<p>Swingpro 200</p> <p>The direction mark should be aligned with the club's front direction and information about swing plane, speed, face angle and others of golf club head will be transmitted to Smart phone with real-time.</p>
	<p>User guide</p> <p>Instruction manual. Please refer to user guide in the App for more details.</p>
	<p>Pouch bag</p> <p>Please keep Swingpro 200 into the pouch bag after using.</p>
	<p>Program of swing analysis (App)</p> <p>This program feeds back the swing motion and results by voice and graphic UI and it could be downloaded from Google play.</p>

Pre-caution



CAUTION

Please review the below notification for user to use this product safely and correctively, preventing unexpected hazard and damage.

Pre-caution

- If a lot of water will flow inside, it could make a wrong operation.
- Please do not change or disjoint product parts.
- Please keep out of high temperature and direct light for a long time.
- Please keep out of high temperature and humidity for a long time.
- Please do not clean product chemically.
- Please keep a Swingpro 200 in a supplied pouch bag after using.
- Supplier is not responsible for products broken by user's carelessness.

Preparing before using

Charging

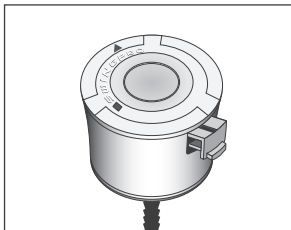

- 1** Please take out charging terminal cover outside.

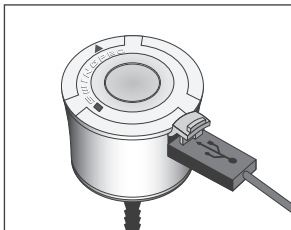

- 2** For charging, please use the Micro USB type charger for Smart phone.

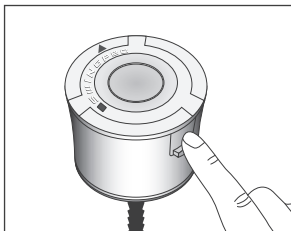

- 3** After full charging, please push cover and insert it into body fully.

Status LED of connecting charger

RED LED flicker	Charging
GREEN LED flicker	Full charging



CAUTION

- Please do not take off cover strongly to prevent some damage.
- The proper Input voltage level is 5V.
Micro USB type charger for Smart phone is usually available.
- After full charge (GREEN LED flicker), please disconnect charge cable and push the cover to close.

Preparing before using

Installing Swingpro 200

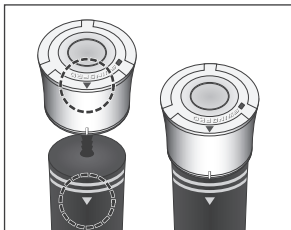

Please push grip insert pin into the grip to align the mounting align marker with grip front mark.



Please dock the swingpro 200 to the grip to align with the front side of club face (or grip mark).

Installing App



QR Code

If user takes a picture of QR code, it is possible to go to App download site automatically.



Google Play

Searching "Swingpro 200" at Google play and installing "Swingpro 200" properly.

Preparing before using

Pairing with Smart phone

According to following steps, pairing and calibration of sensor should be done.

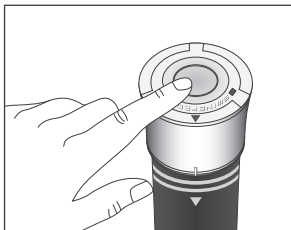

- 1** Please touch “touch switch” button.
If a status LED starts flickering with red, pairing procedure is available.

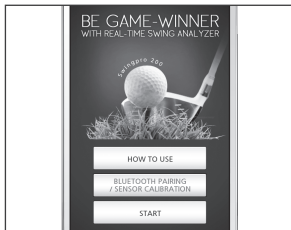

- 2** Execute “Swingpro 200” App and select **BLUETOOTH PAIRING / SENSOR CALIBRATION** button.



- 3** Please touch **Pairing for bluetooth** button.

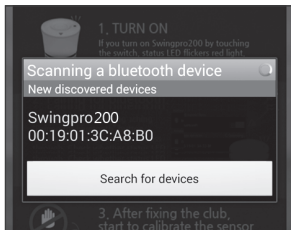

- 4** After touching **Search for devices** button, select “Swingpro200” or Device ID written on the side of the Swingpro 200.

Preparing before using

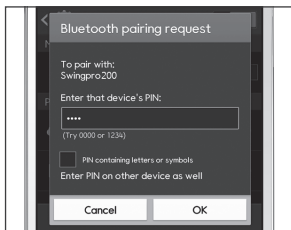

- 5 Entering PIN number "1234" and touching **OK** button, then Bluetooth pairing process will be completed.



- 6 If status LED flickers green light, please set the golf club without any movement.



- 7 If touching a **Sensor calibration** button, sensor calibration will be executed and completed after a while.

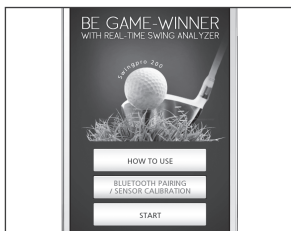

- 8 Touch **START** button, then screen of measurement will be open.

Preparing before using



- 9 If voice guide with “Ready” is announced, Swingpro 200 should be perfectly connected with Smart phone for sensing a swing.

LED status

	RED flicker	GREEN flicker	GREEN off
Charging	Charging	Full charging	—
In using	Stand by	Connecting with App (Swing available)	If there is no any swing motion for 2 minutes during LED Green flicker, Green LED will be off for power save mode. (After touch switch, Green flicker will be started again and swing is available.)

※ If LED is continuously off after touch switch, please check the battery power.

Trouble shooting

Trouble shooting

No status LED signal	If LED flickers after touching switch on top of Swingpro 200, it is a normal operation.
	Please check battery power. When using it firstly or after long time interval, please charge the battery fully.
Not turning LED colour from RED to GREEN during Bluetooth connection	Restart Swingpro 200 App program.
	Please cancel the power save mode at Smart phone. (cancel procedure of power save mode : environment set → power save mode → off)
	Please clear memory or cache area to prevent potential error. (memory clear procedure : press home button for 3 seconds → operating manager → Ram → memory arrangement)
	Please power off and on Samart phone if there is a temporary software error.
	Please check whether LED flickers or not after touching switch.
	Please check whether pairing is set or not. (without pairing, Bluetooth connection is not available.)
No Bluetooth connection	Please check whether charge cable is connected or not. (Bluetooth connection is not available during charging battery.)
	The maximum communication distance between Smart phone and Swingpro 200 is 10m.
	Please check whether Bluetooth function at Smart phone turns on.
Charging is not possible	Please check whether charger or cable is connected properly or not.
	Please check whether battery is charged fully or not.

Specification & Certificate

Specification

Model name	Swingpro 200
Size	36x24 (mm)
Weight	18g
Operating temperature	0 ~ 60 °C
Battery operation time	Continuous operation time : up to 2 hours, Natural discharge time (storage) : 20 days
Bluetooth	Bluetooth ver 2.1 +EDR
Communication distance	Maximum communication distance between Smart phone and Swingpro 200 is 10m
Port	Micro USB for (charging purpose)
Compatible devices	Android devices with Bluetooth (requires Android 2.2 or later)
App market	'Swingpro 200' on Google Play

Certificate



Notification of user compensation

Notification of user compensation

User category			Compensation contents	
			In warranty	Out of warranty
Functional failure during normal operation	Need a serious repair before 10 days after buying		Exchange or re-fund	N/A
	Need a serious repair before 1 months after buying		Exchange or free service	N/A
	Need a repair before 1 months after exchange		Exchange or re-fund	N/A
	Not available for exchanging within 1 month		Re-fund	N/A
	Repairable	Within 3 times as the same defect	Free service	Repair at a cost
		Within 4 times as the same defect	Exchange, re-fund	Repair at a cost
		Within 5 times as the various defect		
	Not repairable	Returned product is lost	Exchange, re-fund	Exchange by getting depreciation
		Not available within 1 month for repair		
Not available for exchange		Re-fund	Re-fund with residual value plus 10% (maximum price : purchase price)	
Performance and functional failure by consumer's mistake and miss-using	Repairable		Repair at a cost	
	Not repairable due to no spare parts		Exchange after getting fund same with repair at a cost	
<div>▪ Failure caused by natural disasters. (fire, salt damage, gas, earthquake, storm and flood damage, etc.)</div> <div>▪ Failures caused by problem with the input power or connection unit .</div> <div>▪ Exchanging expendable parts by normal wear and tear.</div> <div>▪ Failures caused by external causes without product causes.</div> <div>▪ Failure caused by repairing by un-authorized person besides Du-sung's agency and customer support center.</div>			Repair at a cost	

- Complying with customer compensation regulations. Keeping spare parts for 3 years.
One year warranty period from the date of purchase.
- Exchange with the same product and refund with the same issued receipt.
- In case of the issued receipt (with additional cost) higher than normal price, following normal price.

Warranty notification & Guarantee

Warranty notification

Model	Swingpro 200	Serial number	
Where to Buy		Date of purchase	
Warranty Period	1 year	Free A/S	One year from the date of purchase

Thank you very much for purchasing this product.

If the date of purchase is not clear, warranty period will be calculated from 3 months after manufacturing date.

Du-sung Technology co., Ltd enforces warranty on product as below in accordance with the standard of consumer dispute resolution.

Guarantee

- Du-sung Technology co., Ltd enforces any warranty on product as below in accordance with consumer compensation regulations.
- During the warranty period, Du-sung Technology co., Ltd should repair or exchange the defective product which is belong to warranty category.
- Du-sung Technology co., Ltd should re-fund within a certain period of time in case that repair and exchange within the warranty category is not available.
- Du-sung Technology co., Ltd has no obligation to repair, exchange or re-fund until customer returns defective product.
- Warranty on the product distributed by Du-sung Technology co., Ltd will be available to countries where the product has been initially marketed.
- Du-sung Technology co., Ltd do not warranty that software error won't occur at product.

Customer Center

+82-42-936-8166

www.swingpro.co.kr



75, Sinilseo-ro, Daedeok-gu, Daejeon, Korea 306~230

Tel : +82-42-936-8166 Fax : +82-42-936-8169

E-mail : sales@du-sung.com